

This drawing is copyright.  
Do not scale from prints.  
Contractors are to check all  
dimensions on site before  
ordering materials.

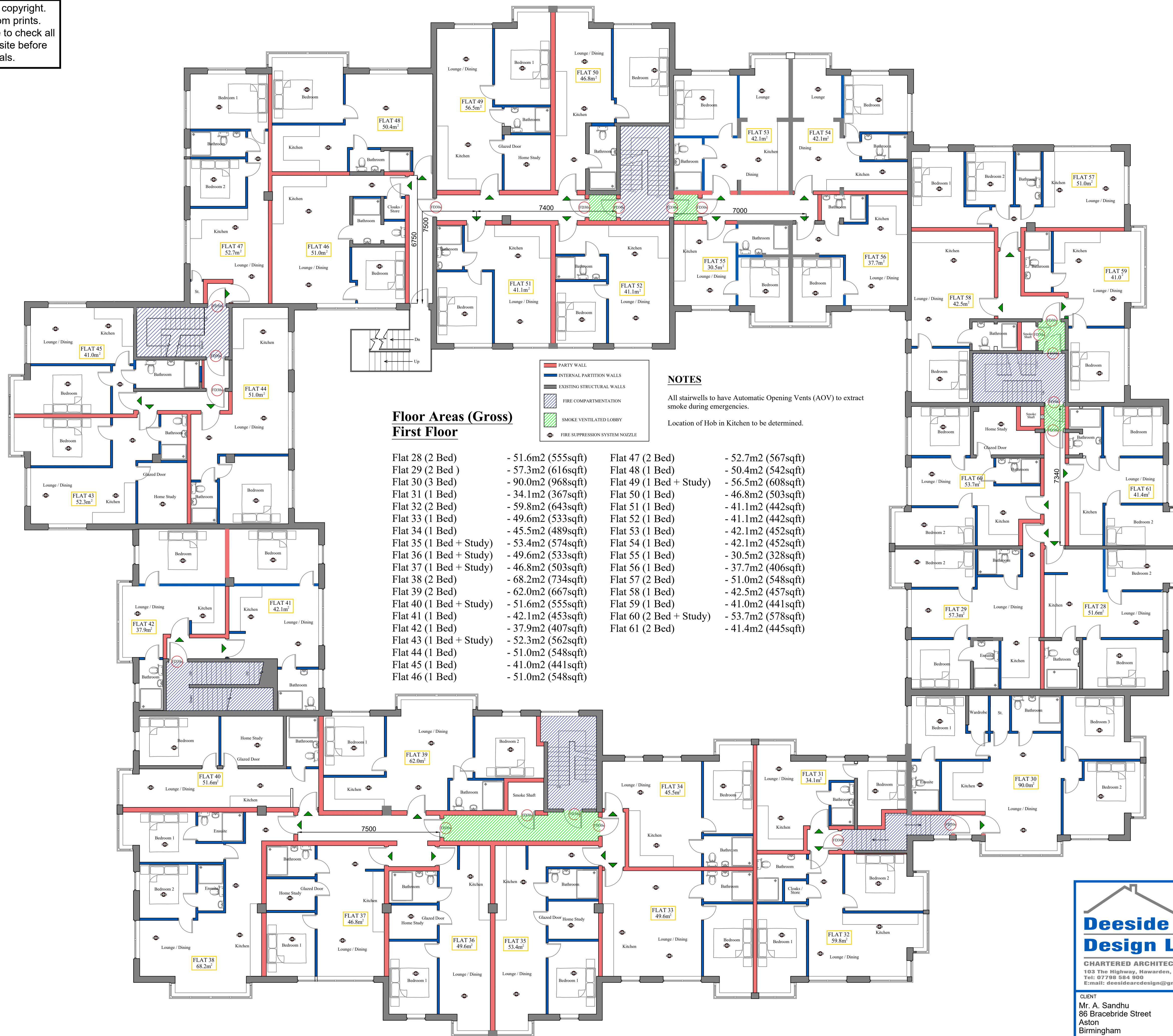

**Floor Areas (Gross)  
First Floor**

Flat 28 (2 Bed)	- 51.6m <sup>2</sup> (555sqft)	Flat 47 (2 Bed)	- 52.7m <sup>2</sup> (567sqft)
Flat 29 (2 Bed)	- 57.3m <sup>2</sup> (616sqft)	Flat 48 (1 Bed)	- 50.4m <sup>2</sup> (542sqft)
Flat 30 (3 Bed)	- 90.0m <sup>2</sup> (968sqft)	Flat 49 (1 Bed + Study)	- 56.5m <sup>2</sup> (608sqft)
Flat 31 (1 Bed)	- 34.1m <sup>2</sup> (367sqft)	Flat 50 (1 Bed)	- 46.8m <sup>2</sup> (503sqft)
Flat 32 (2 Bed)	- 59.8m <sup>2</sup> (643sqft)	Flat 51 (1 Bed)	- 41.1m <sup>2</sup> (442sqft)
Flat 33 (1 Bed)	- 49.6m <sup>2</sup> (533sqft)	Flat 52 (1 Bed)	- 41.1m <sup>2</sup> (442sqft)
Flat 34 (1 Bed)	- 45.5m <sup>2</sup> (489sqft)	Flat 53 (1 Bed)	- 42.1m <sup>2</sup> (452sqft)
Flat 35 (1 Bed + Study)	- 53.4m <sup>2</sup> (574sqft)	Flat 54 (1 Bed)	- 42.1m <sup>2</sup> (452sqft)
Flat 36 (1 Bed + Study)	- 49.6m <sup>2</sup> (533sqft)	Flat 55 (1 Bed)	- 30.5m <sup>2</sup> (328sqft)
Flat 37 (1 Bed + Study)	- 46.8m <sup>2</sup> (503sqft)	Flat 56 (1 Bed)	- 37.7m <sup>2</sup> (406sqft)
Flat 38 (2 Bed)	- 68.2m <sup>2</sup> (734sqft)	Flat 57 (2 Bed)	- 51.0m <sup>2</sup> (548sqft)
Flat 39 (2 Bed)	- 62.0m <sup>2</sup> (667sqft)	Flat 58 (1 Bed)	- 42.5m <sup>2</sup> (457sqft)
Flat 40 (1 Bed + Study)	- 51.6m <sup>2</sup> (555sqft)	Flat 59 (1 Bed)	- 41.0m <sup>2</sup> (441sqft)
Flat 41 (1 Bed)	- 42.1m <sup>2</sup> (453sqft)	Flat 60 (2 Bed + Study)	- 53.7m <sup>2</sup> (578sqft)
Flat 42 (1 Bed)	- 37.9m <sup>2</sup> (407sqft)	Flat 61 (2 Bed)	- 41.4m <sup>2</sup> (445sqft)
Flat 43 (1 Bed + Study)	- 52.3m <sup>2</sup> (562sqft)		
Flat 44 (1 Bed)	- 51.0m <sup>2</sup> (548sqft)		
Flat 45 (1 Bed)	- 41.0m <sup>2</sup> (441sqft)		
Flat 46 (1 Bed)	- 51.0m <sup>2</sup> (548sqft)		

**NOTES**

All stairwells to have Automatic Opening Vents (AOV) to extract smoke during emergencies.  
Location of Hob in Kitchen to be determined.

REVISION	AMENDMENT	DATE
C	VENTILATION LOBBIES AND FIRE SPRINKLER NOZZLES ADDED	05.01.21
B	GENERAL AMENDMENTS FOLLOWING CONSULTATION WITH FIRE STRATEGY CONSULTANT	01.01.21
A	FLATS 29, 30, 35, 36, 38 & 40 AMENDED	15.12.20

**Deeside Architectural Design Limited**  
 CHARTERED ARCHITECTS, TECHNICIANS, SURVAYORS  
 103 The Highway, Hawarden, Flintshire, CH5 3DL  
 Tel: 07798 584 900  
 E-mail: deesidearchdesign@gmail.com Website: deesidearch.co.uk

CLIENT: Mr. A. Sandhu, 86 Bracebride Street, Aston, Birmingham

DRAWING TITLE: Proposed Residential Development, Swan Court, Charles Edward Road, Birmingham

DATE: Oct '20  
 SCALE: 1:100

DRAWING No.: 2020/25/PFF  
 REV: C

PROPOSED FIRST FLOOR PLAN

