

This drawing is copyright.
Do not scale from prints.
Contractors are to check all
dimensions on site before
ordering materials.

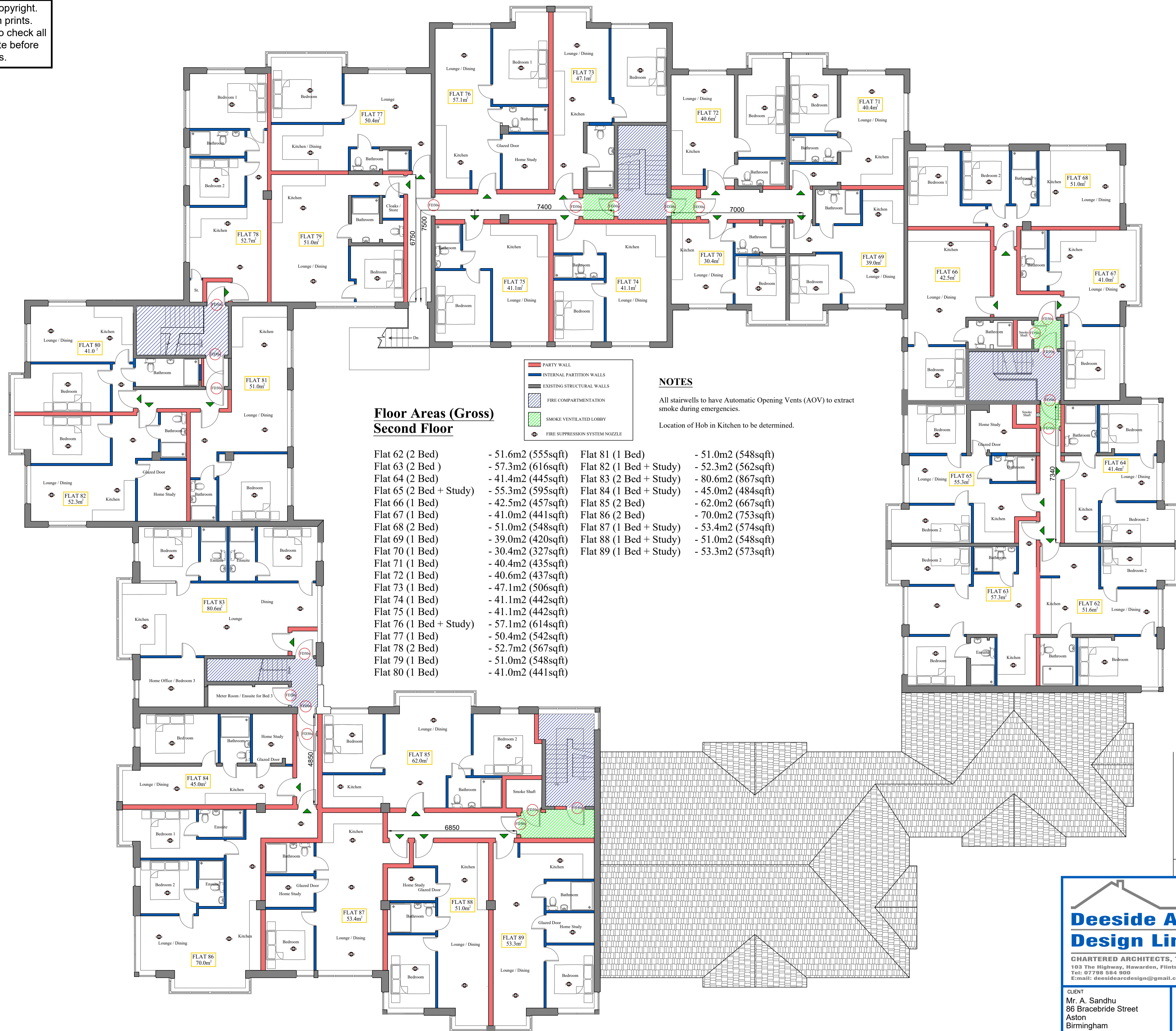

**Floor Areas (Gross)
Second Floor**

| | | | |
|-------------------------|--------------------|-------------------------|--------------------|
| Flat 62 (2 Bed) | - 51.6m2 (555sqft) | Flat 81 (1 Bed) | - 51.0m2 (548sqft) |
| Flat 63 (2 Bed) | - 57.3m2 (616sqft) | Flat 82 (1 Bed + Study) | - 52.3m2 (562sqft) |
| Flat 64 (2 Bed) | - 41.4m2 (445sqft) | Flat 83 (2 Bed + Study) | - 80.6m2 (867sqft) |
| Flat 65 (2 Bed + Study) | - 55.3m2 (595sqft) | Flat 84 (1 Bed + Study) | - 45.0m2 (484sqft) |
| Flat 66 (1 Bed) | - 42.5m2 (457sqft) | Flat 85 (2 Bed) | - 62.0m2 (667sqft) |
| Flat 67 (1 Bed) | - 41.0m2 (441sqft) | Flat 86 (2 Bed) | - 70.0m2 (753sqft) |
| Flat 68 (2 Bed) | - 51.0m2 (548sqft) | Flat 87 (1 Bed + Study) | - 53.4m2 (574sqft) |
| Flat 69 (1 Bed) | - 39.0m2 (420sqft) | Flat 88 (1 Bed + Study) | - 51.0m2 (548sqft) |
| Flat 70 (1 Bed) | - 30.4m2 (327sqft) | Flat 89 (1 Bed + Study) | - 53.3m2 (573sqft) |
| Flat 71 (1 Bed) | - 40.4m2 (435sqft) | | |
| Flat 72 (1 Bed) | - 40.6m2 (437sqft) | | |
| Flat 73 (1 Bed) | - 47.1m2 (506sqft) | | |
| Flat 74 (1 Bed) | - 41.1m2 (442sqft) | | |
| Flat 75 (1 Bed) | - 41.1m2 (442sqft) | | |
| Flat 76 (1 Bed + Study) | - 57.1m2 (614sqft) | | |
| Flat 77 (1 Bed) | - 50.4m2 (542sqft) | | |
| Flat 78 (2 Bed) | - 52.7m2 (567sqft) | | |
| Flat 79 (1 Bed) | - 51.0m2 (548sqft) | | |
| Flat 80 (1 Bed) | - 41.0m2 (441sqft) | | |

NOTES

All stairwells to have Automatic Opening Vents (AOV) to extract smoke during emergencies.
Location of Hob in Kitchen to be determined.

| REVISION | AMENDMENT | DATE |
|----------|---|----------|
| C | VENTILATION LOBBIES AND FIRE SPRINKLER NOZZLES ADDED | 05.01.21 |
| B | GENERAL AMENDMENTS FOLLOWING CONSULTATION WITH FIRE STRATEGY CONSULTANT | 01.01.21 |
| A | FLATS 86 & 89 AMENDED | 15.12.20 |

Deeside Architectural Design Limited
 CHARTERED ARCHITECTS, TECHNICIANS, SURVAYORS
 103 The Highway, Hawarden, Flintshire, CH5 3DL
 Tel: 07798 584 900
 E-mail: deesidearchdesign@gmail.com Website: deesidearch.co.uk

CLIENT: Mr. A. Sandhu, 86 Bracebride Street, Aston, Birmingham

DRAWING TITLE: Proposed Residential Development, Swan Court, Charles Edward Road, Birmingham

DATE: Nov '20
 SCALE: 1:100

DRAWING NO.: 2020/25/PSF
 REV: C

PROPOSED SECOND FLOOR PLAN